

OFFICE SPACE FOR LEASE COLUMBIA BUSINESS PARK A

2033-2057 SUMMERSWEET DRIVE • BOISE, IDAHO 83716



PROPERTY INFORMATION:

Submarket:	Southeast	Lease Term:	3-5 Years
Bldg Type:	Office	Lease Type:	NNN
Bldg Size:	15,670 SF	Est. NNN's:	\$3.79/SF
# of Floors:	1	TI Allowance:	Negotiable
Parking:	5:1,000	Divisible:	Yes
Zoning:	M-1 Light Industrial	Available:	Immediately

AVAILABLE SPACE:

SPACE	RSF	RATE
Suite 2033	2,103 SF	\$11.50/SF, NNN
Suite 2057	3,005 SF	\$11.50/SF, NNN

Suites 2033 and 2057 may be combined for 5,108 SF.

CONTACT:

Nick Schuitemaker

Ph: 208.947.0802
nick@tokcommercial.com

Mike Greene, CCIM, SIOR

Ph: 208.947.0835
mikeg@tokcommercial.com

Peter Oliver, CCIM, SIOR

Ph: 208.947.0816
peter@tokcommercial.com



LISTING COMMENTS:

- Easy access to I-84 and downtown.
- Tilt-up construction - flexible design.
- Federal Way visibility - signage available.
- Excellent professional location in Southeast Boise.
- Close proximity to Micron headquarters and airport.

OFFICE SPACE FOR LEASE COLUMBIA BUSINESS PARK A

2033-2057 SUMMERSWEET DRIVE • BOISE, IDAHO 83716

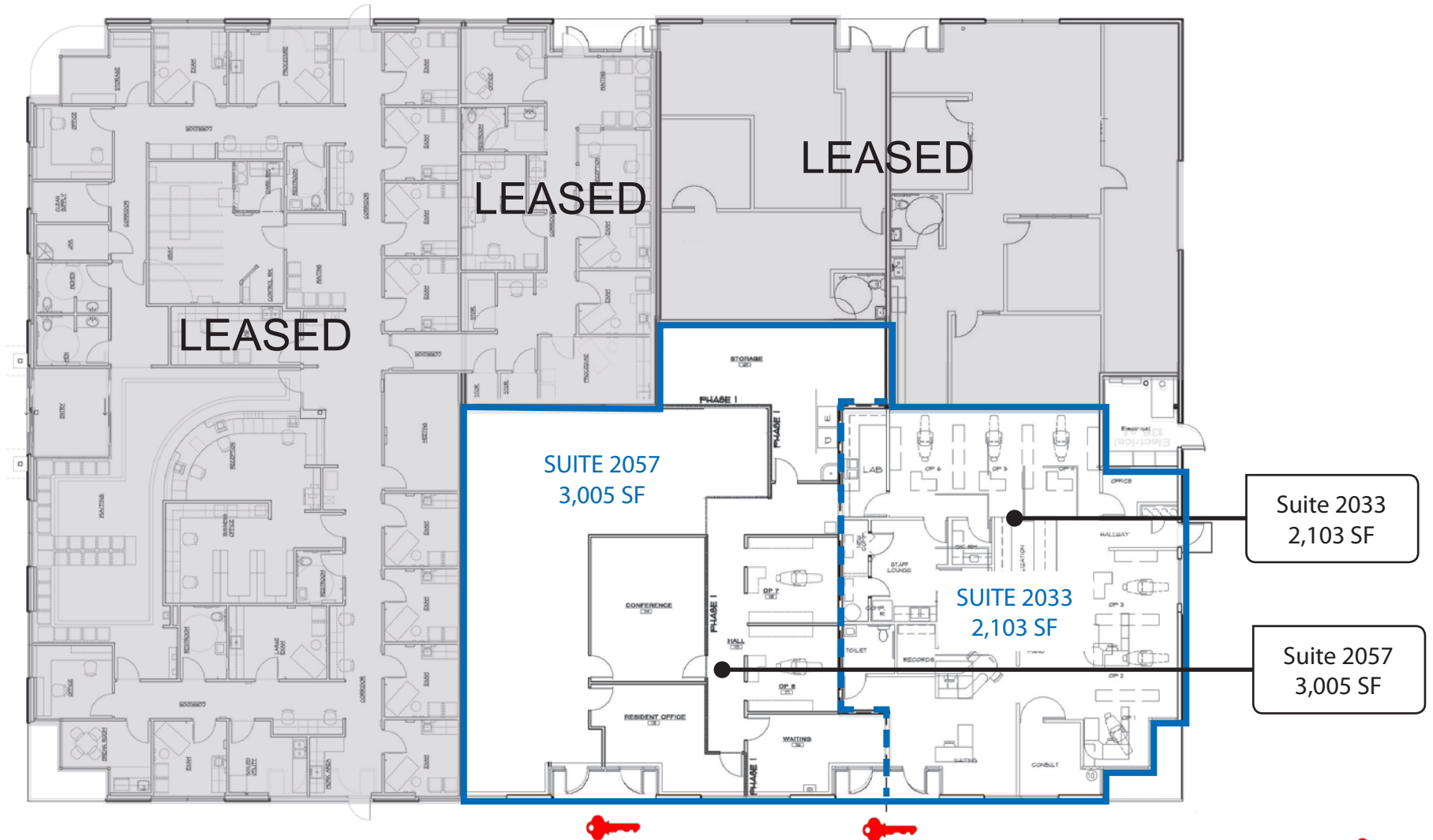

SUITES 2033 AND 2057 MAY BE COMBINED FOR 5,108 SF

Lockbox

This information was obtained from sources believed reliable but cannot be guaranteed. Any opinions or estimates are used for example only.

OFFICE SPACE FOR LEASE COLUMBIA BUSINESS PARK A

2033-2057 SUMMERSWEET DRIVE • BOISE, IDAHO 83716

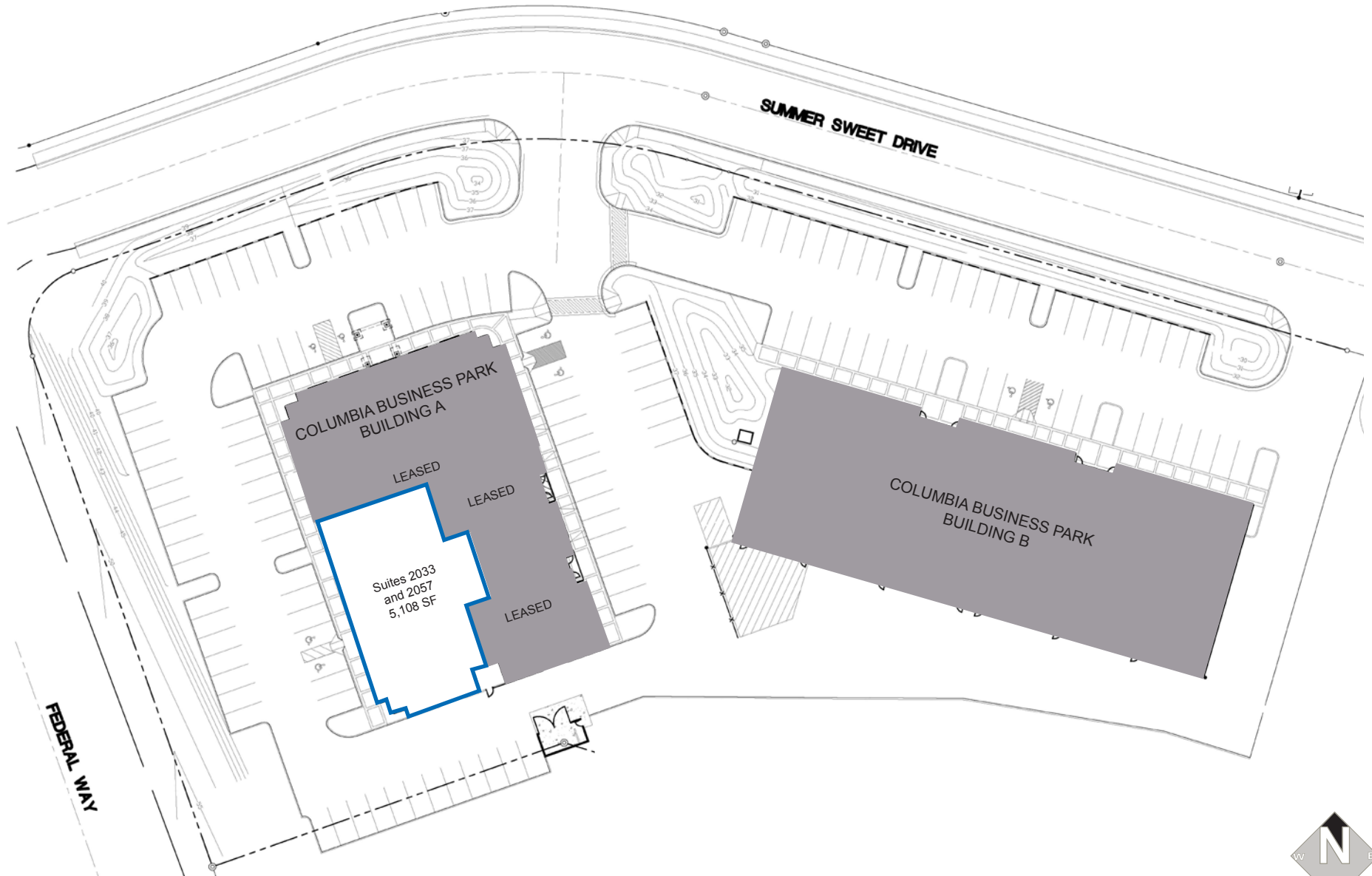

This information was obtained from sources believed reliable but cannot be guaranteed. Any opinions or estimates are used for example only.