

WESTPARK MARKETPLACE

9000 EMERALD - BOISE, ID

RETAIL / OFFICE SPACE FOR LEASE



PROPERTY INFORMATION:

Submarket: West
Available: Immediately
Bldg Type: Retail
Bldg Size: 17,404 SF
Divisible: To 974 SF
Completed: 1998

LEASE TERMS:

Lease Term: 5 yrs
Lease Type: NNN
Est. NNN: \$7.00/SF

THORNTON OLIVER KELLER
COMMERCIAL REAL ESTATE

Experience Results.

CONTACT:

Bob Mitchell, CSM
Ph: 208.947.0836
Fx: 208.947.0869
bob@tokcommercial.com
www.tokcommercial.com



AVAILABLE SPACE:

<u>SPACE:</u>	<u>RSF:</u>	<u>RATE:</u>
Ste. 800	1,263 SF	\$14.00
Ste. 900	974 SF	\$14.00

DEMOGRAPHICS

Population: 88,732 (3 mi.)
HH Income: \$61,060 (3 mi.)

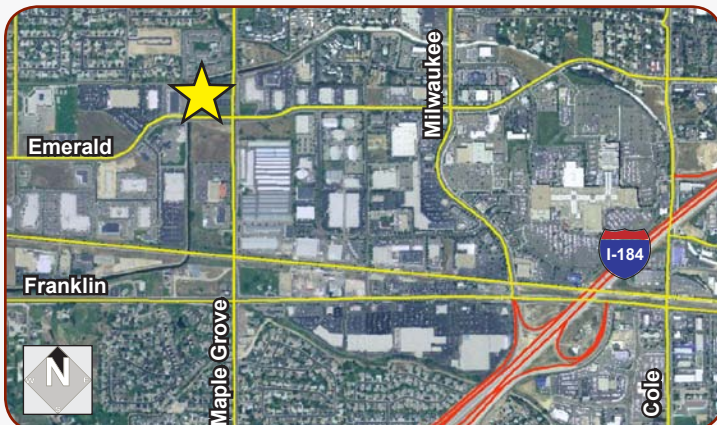

LISTING COMMENTS:

974 SF - ideal for insurance, mortgage, wireless, etc.

Maple Grove road widening complete.

Over 40,000 cars per day!

(05/25/11) This information was obtained from sources believed reliable but cannot be guaranteed. Any opinions or estimates are used for example only.

WESTPARK MARKETPLACE

9000 EMERALD - BOISE, ID

RETAIL / OFFICE SPACE FOR LEASE

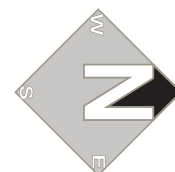
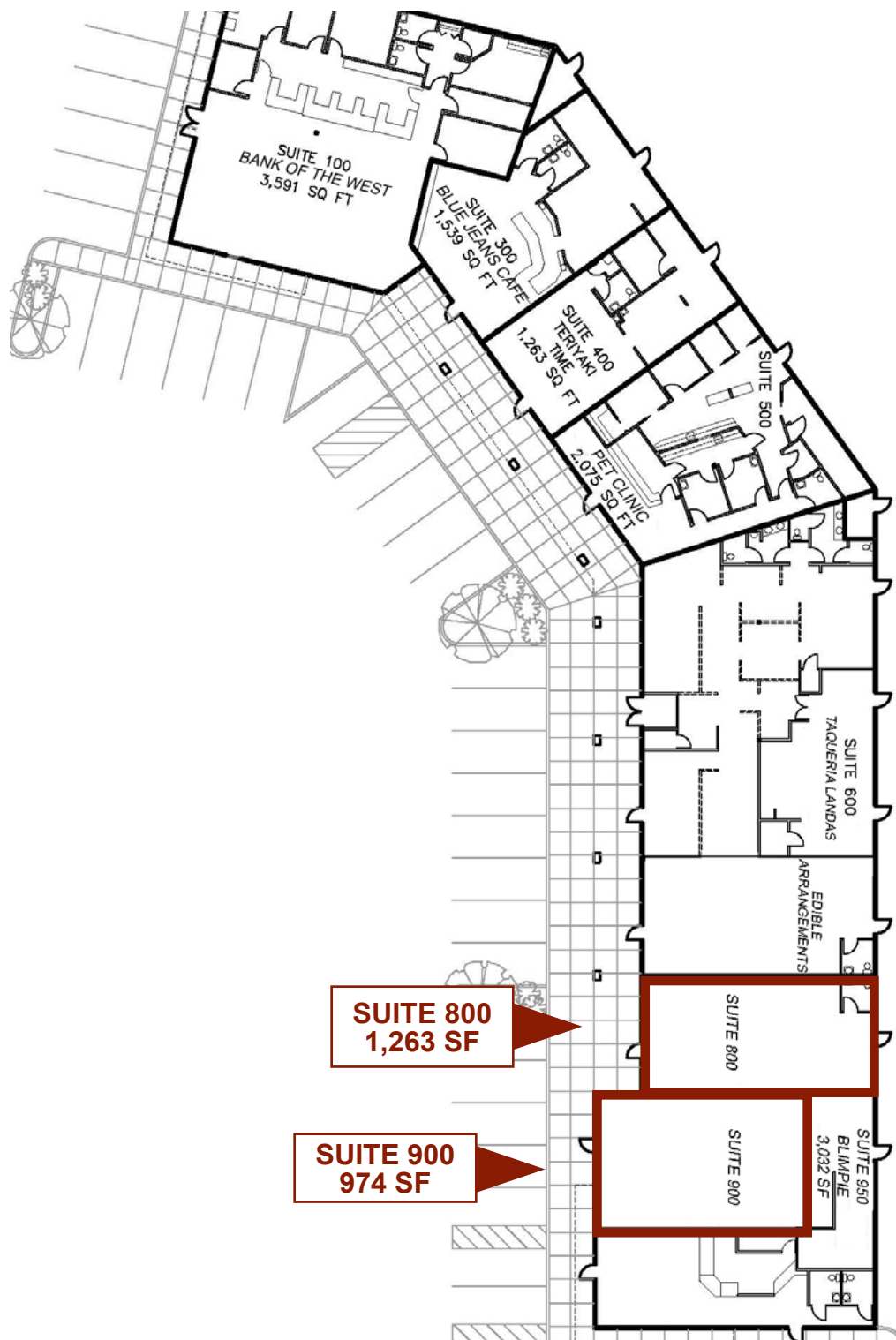

This information was obtained from sources believed reliable but cannot be guaranteed. Any opinions or estimates are used for example only.

WESTPARK MARKETPLACE

9000 EMERALD - BOISE, ID

RETAIL / OFFICE SPACE FOR LEASE

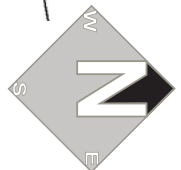
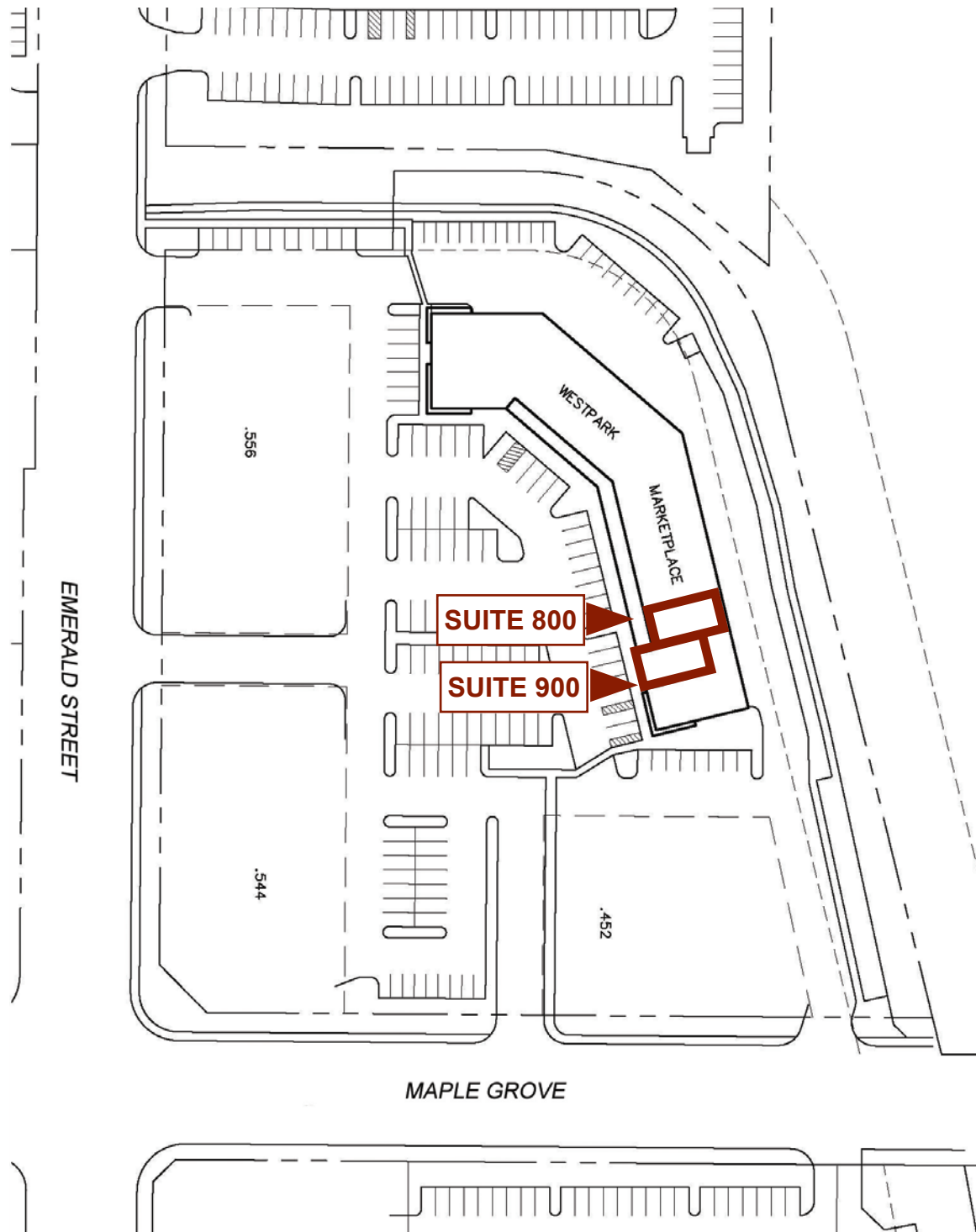

This information was obtained from sources believed reliable but cannot be guaranteed. Any opinions or estimates are used for example only.