

Midtowne Spectrum

2111 N. Cassia - Nampa, ID

RETAIL SPACE FOR LEASE / SUBLEASE



Demographics:

Population: 42,541 (3 mi.)
HH Income: \$53,576 (3 mi.)
 2009

Key Tenants:

Anchored by Home Depot & Edwards Theaters. Other tenants: Red Robin, Golden Corral, Washington Trust, Blimpie's, Moxie Java, Yen Ching, HobbyTown USA, Buffalo Wild Wings, IOU Sushi and Big Chill Frozen Yogurt.

Listing Comments:

The shopping and entertainment center of Canyon County.

Ample parking.

Constant daytime, evening and weekend traffic.

Excellent co-tenancy.

Direct interstate access.

Available Space:

SPACE:	RSF:	RATE/SF:
2119 - Sublease thru 6/2013	1,200 SF	\$13.95
2121	2,142 SF	\$15.95

Lease Terms:

Lease Type: NNN

Contact:

Ben Zamzow, CCIM, CLS

Ph: 208.947.5514

Fx: 208.947.0869

benz@tokcommercial.com

www.tokcommercial.com

Bob Mitchell, CSM

Ph: 208.947.0836

Fx: 208.947.0869

bob@tokcommercial.com

www.tokcommercial.com



(02/06/12)

This information was obtained from sources believed reliable but cannot be guaranteed. Any opinions or estimates are used for example only.

Midtowne Spectrum

2111 N. Cassia - Nampa, ID

RETAIL SPACE FOR LEASE / SUBLEASE



This information was obtained from sources believed reliable but cannot be guaranteed. Any opinions or estimates are used for example only.

Midtowne Spectrum

2111 N. Cassia - Nampa, ID

RETAIL SPACE FOR LEASE / SUBLEASE

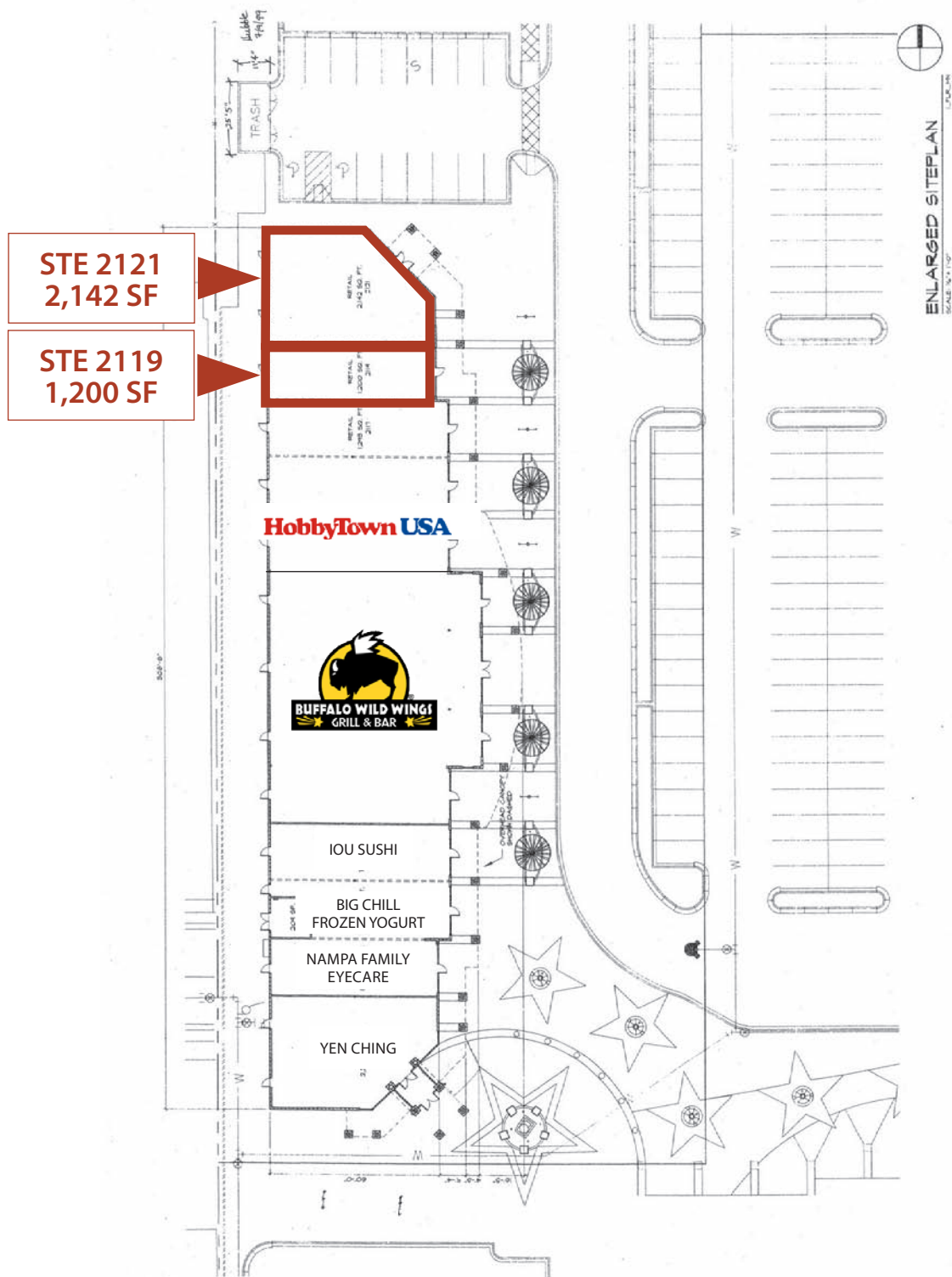

This information was obtained from sources believed reliable but cannot be guaranteed. Any opinions or estimates are used for example only.

Midtowne Spectrum

2111 N. Cassia - Nampa, ID

RETAIL SPACE FOR LEASE / SUBLEASE

Monument Sign

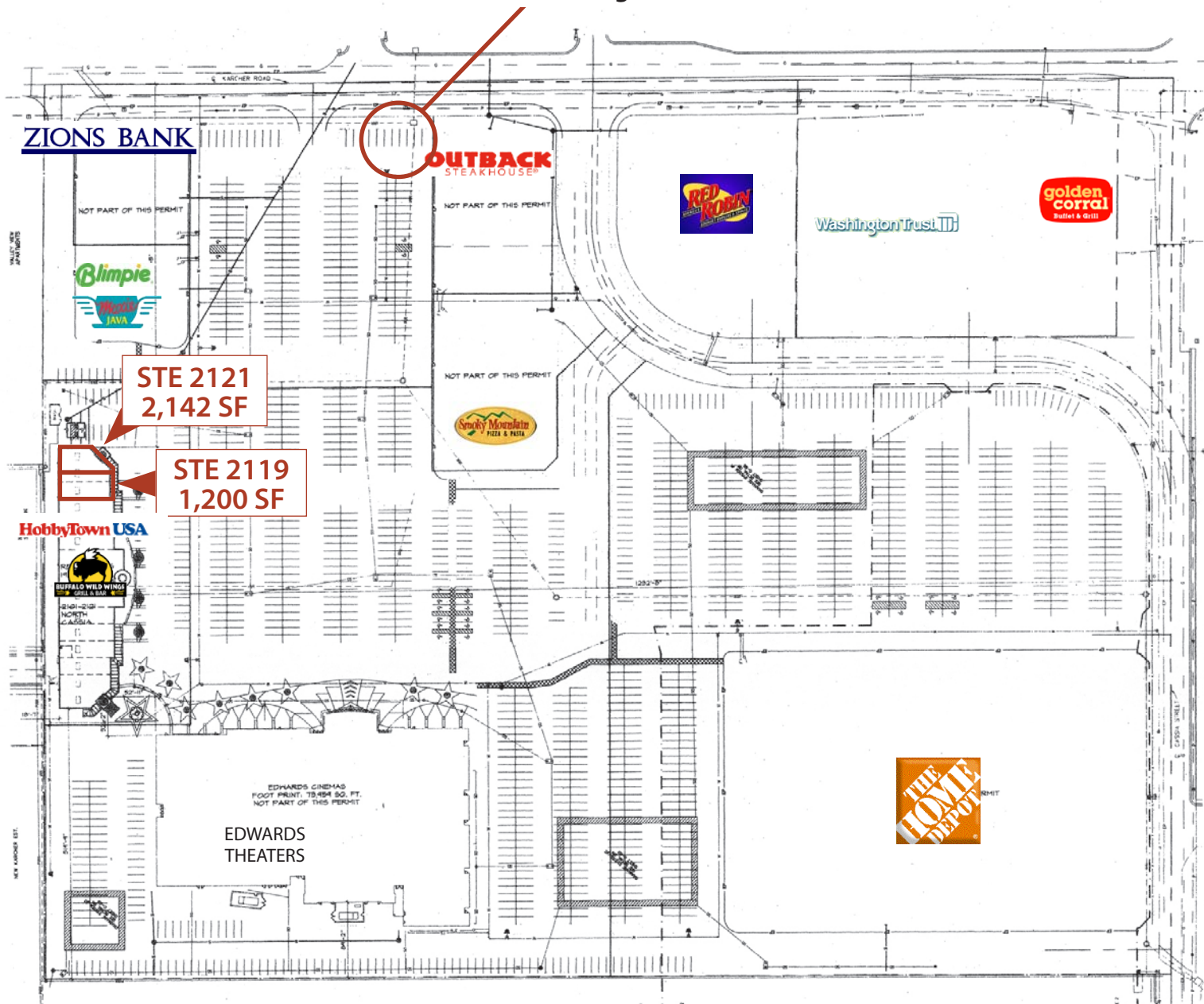

This information was obtained from sources believed reliable but cannot be guaranteed. Any opinions or estimates are used for example only.