

Lakepointe Centre I

300 Mallard Drive - Boise, ID
OFFICE SPACE FOR LEASE



Property Information:

Submarket: Southeast
Available: Immediately
Bldg Type: Office
Quality: Class A
Bldg Size: 64,030 SF
Divisible: Yes
of Floors: 3
Parking: Free surface

Lease Terms:

Lease Term: 5 years
Lease Type: Full Service
TI Allowance: Negotiable
Lease Rate: \$19.50 - \$21.00

Listing Comments:

- Premiere Parkcenter location on the lake with views.
- Restaurants, lodging and retail services within walking distance.
- Excellent views of the mountains and lake.
- Premium quality office space and on-site amenities.
- New Parkcenter bridge offers easy access to Downtown Boise and I-84 Connector.

Available Space:

SPACE:	RSF:	RATE:
Suite 100	986 SF	Contact Agent
Suite 110	1,354 SF	Contact Agent
Suite 120	2,350 SF	Contact Agent

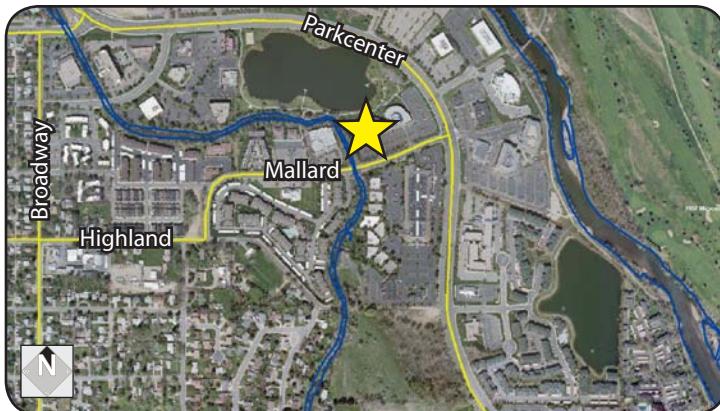

Contact:

Patrick Shalz, SIOR
Ph: 208.947.0834
Fx: 208.947.0869
pat@tokcommercial.com
www.tokcommercial.com



Grove T. Hummert
Ph: 208.947.0804
Fx: 208.947.0869
grove@tokcommercial.com
www.tokcommercial.com

Lakepointe Centre I

300 Mallard Drive - Boise, ID

OFFICE SPACE FOR LEASE

First Floor

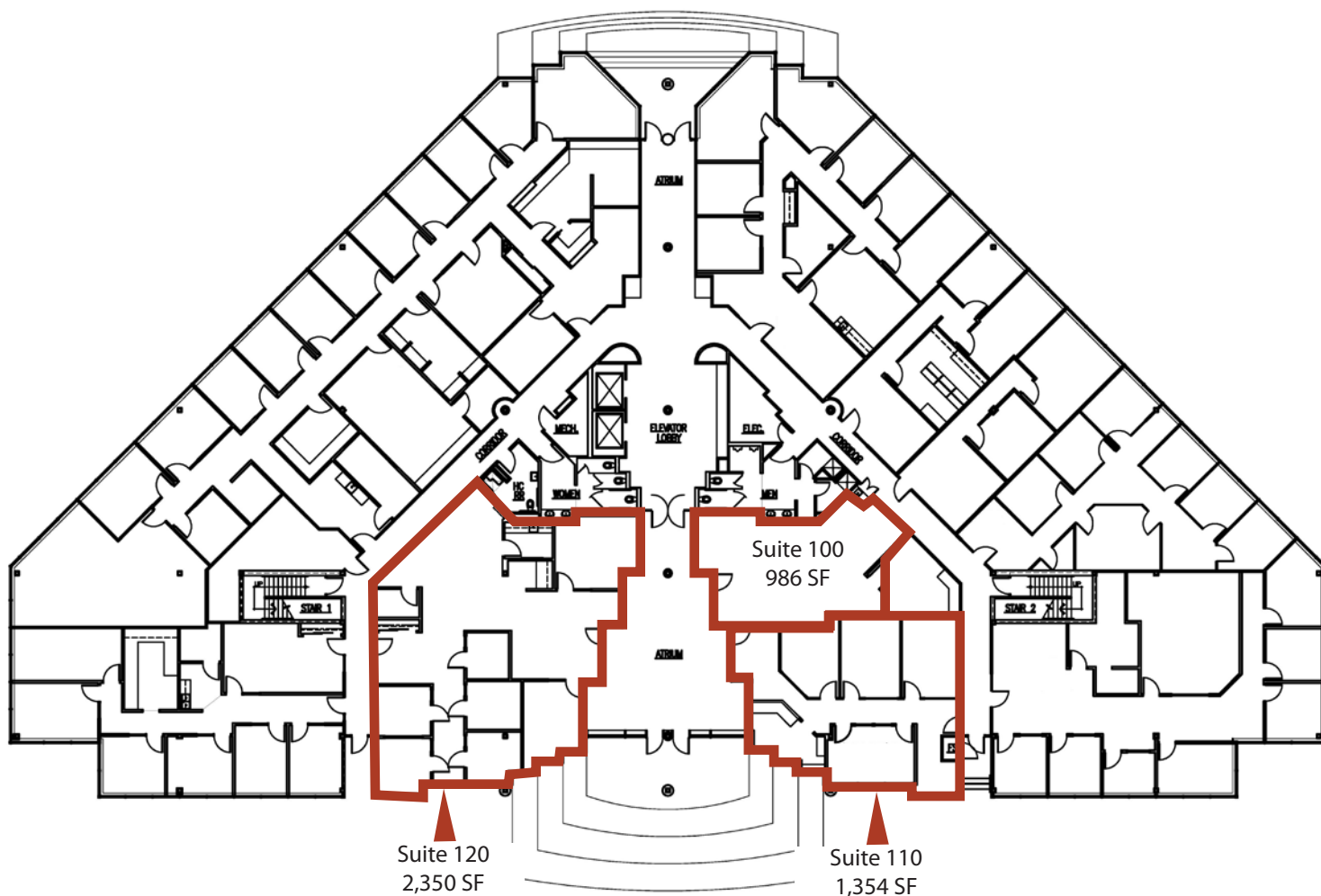

This information was obtained from sources believed reliable but cannot be guaranteed. Any opinions or estimates are used for example only.