

Franklin & Orchard Pad

101 S Orchard - Boise, ID
DEVELOPMENT LAND FOR SALE



Demographics:

Population: 13,987 (1 Mile) • 101,589 (3 Mile)
HH Income: \$51,577 (1 Mile) • \$57,988 (3 Mile)
2010

Listing Comments

Hard corner, grocery anchored pad for only \$365,000!

Located at the corner of Franklin & Orchard with vpd of 32,112 vpd.

Highly underserved market!

Excellent visibility and access.

Surrounded by dense residential neighborhoods & large daytime workforce.

Available:

Size: 0.54 Acres
Price: \$365,000
Zoning: C-2D
Survey: Available
Phase I: Available

Contact:

Ben Zamzow, CCIM, CLS

Ph: 208.947.5514

Fx: 208.947.0869

benz@tokcommercial.com

www.tokcommercial.com



Franklin & Orchard Pad

101 S Orchard - Boise, ID
DEVELOPMENT LAND FOR SALE

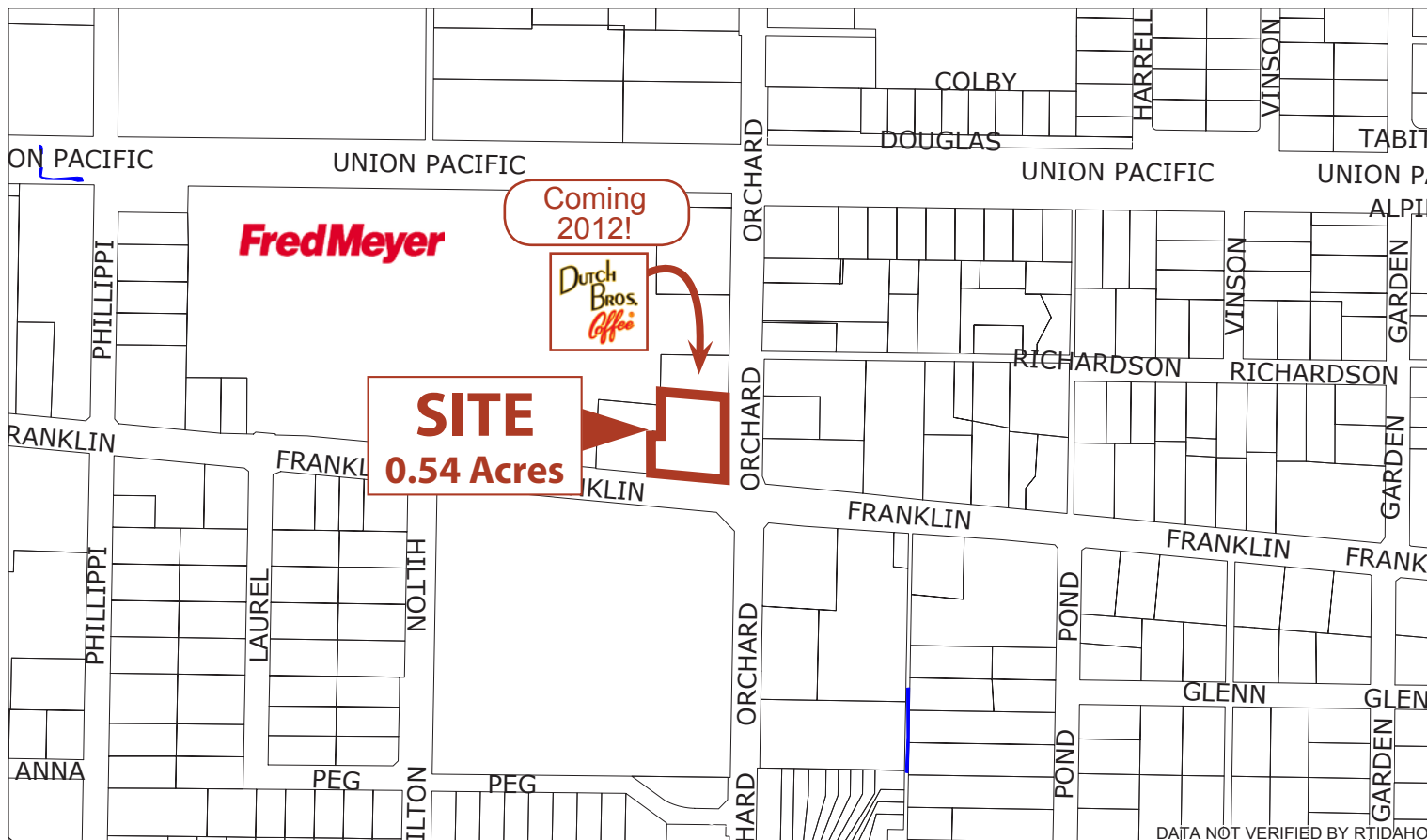

SCALE 1 : 3,160



This information was obtained from sources believed reliable but cannot be guaranteed. Any opinions or estimates are used for example only.

Franklin & Orchard Pad

101 S Orchard - Boise, ID
DEVELOPMENT LAND FOR SALE

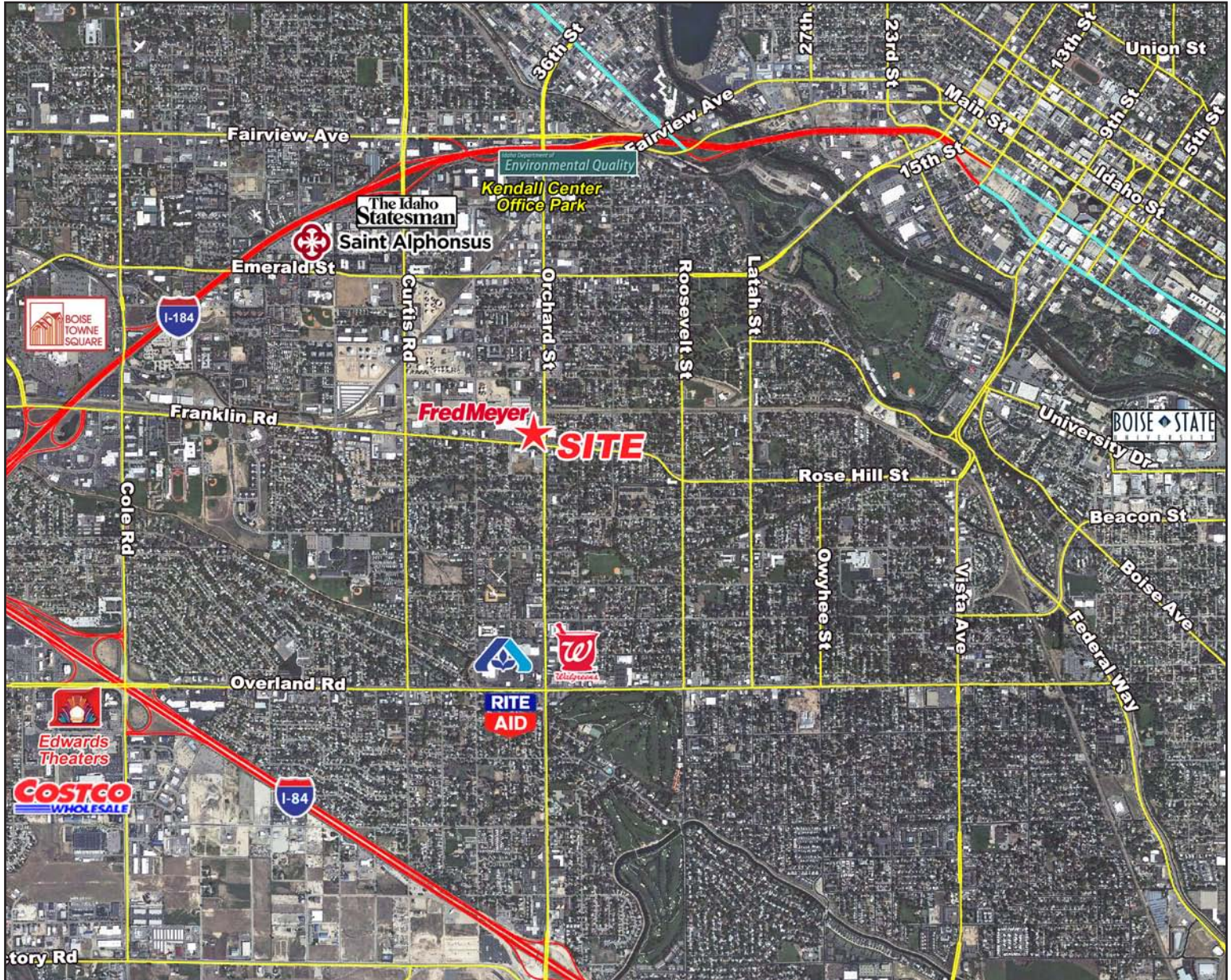

This information was obtained from sources believed reliable but cannot be guaranteed. Any opinions or estimates are used for example only.