

Central Park Commerce

Bldgs. A & B - 2230 & 2240 S. Cole Road - Boise, ID
RETAIL / SHOWROOM / WAREHOUSE SPACE FOR LEASE



Property Information:

Submarket:	Southwest
Bldg Type:	Industrial
Bldg Sizes:	25,256 SF • 26,180 SF
Clear Height:	20' - 22'
Dock Doors:	Yes
Grade Level:	Yes
Power:	Ample
Zoning:	M-3
Parking:	Ample
Lease Term:	3 - 5 Years
Lease Type:	NNN
NNN Costs:	\$0.16/SF (Estimate)

Listing Comments:

- Flexible, multi-use, dock-high building.
- Excellent central location with retail visibility.
- Close to restaurants and services.
- Only 1/2 mile from I-84.

Available Space:

SPACE:	RSF:	MONTHLY:
Bldg A	Shwrom 1,250 SF	
Ste 140	Whse 1,404 SF	\$1,459.70
Bldg B		
Ste 130-B	Whse 4,335 SF	\$1,300.50
	Total 6,989 SF	\$2,760.20



(07/07/11)

This information was obtained from sources believed reliable but cannot be guaranteed. Any opinions or estimates are used for example only.

Contact:

Dan Minnaert, SIOR, CCIM

Ph: 208.947.0845
Fx: 208.947.0869
dan@tokcommercial.com
www.tokcommercial.com

Devin Pierce

Ph: 208.947.0850
Fx: 208.947.0869
devin@tokcommercial.com
www.tokcommercial.com



Central Park Commerce

Bldgs. A & B - 2230 & 2240 S. Cole Road - Boise, ID
RETAIL / SHOWROOM / WAREHOUSE SPACE FOR LEASE

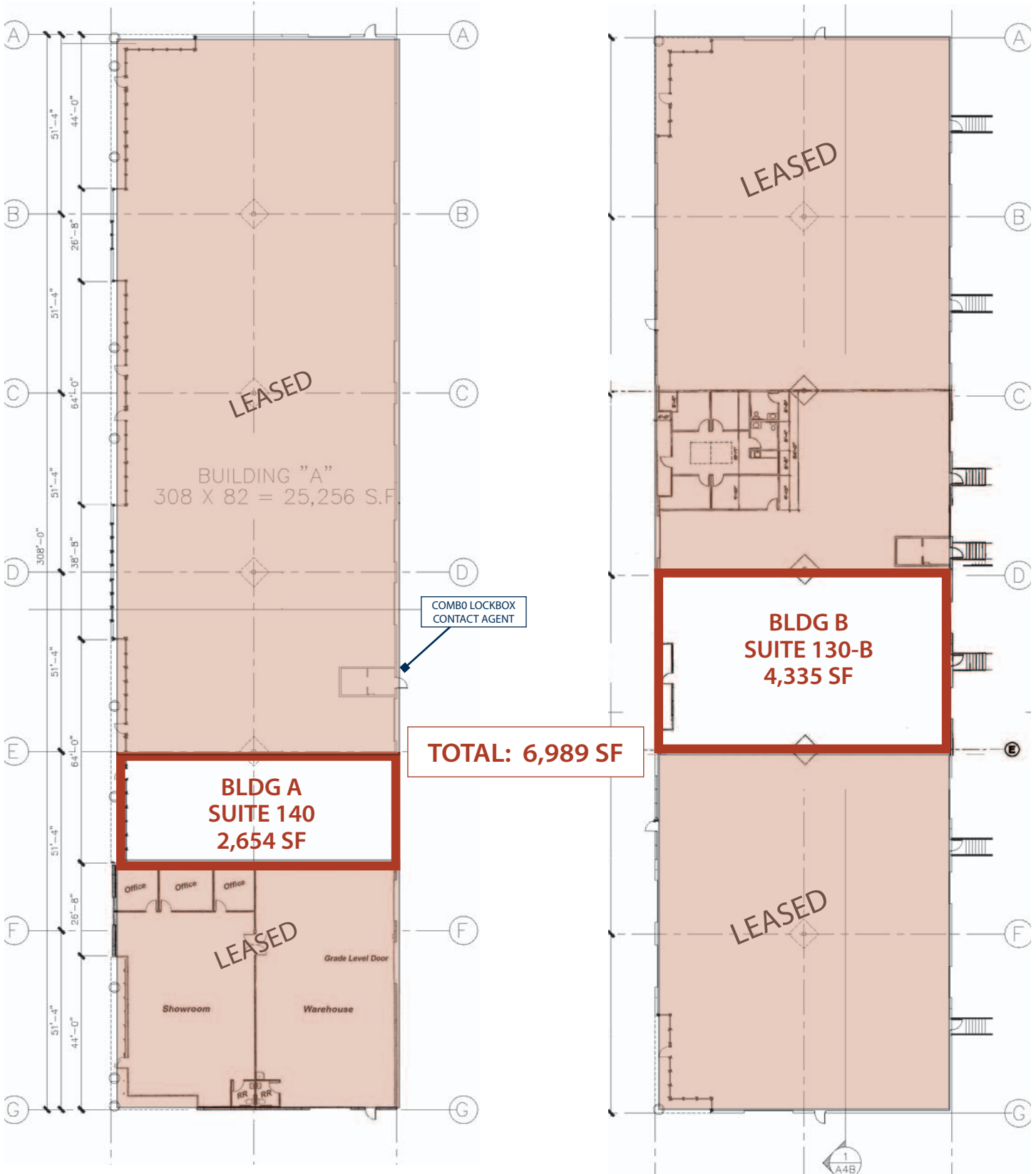

This information was obtained from sources believed reliable but cannot be guaranteed. Any opinions or estimates are used for example only.

Central Park Commerce

Bldgs. A & B - 2230 & 2240 S. Cole Road - Boise, ID
RETAIL / SHOWROOM / WAREHOUSE SPACE FOR LEASE



This information was obtained from sources believed reliable but cannot be guaranteed. Any opinions or estimates are used for example only.