

Airport Distribution Center

1051 - 1287 Boeing St. - Boise, ID
OFFICE / WAREHOUSE SPACE FOR LEASE



Property Information:

Submarket:	Airport
Available:	Immediately
Bldg Type:	Office/Warehouse
Divisible:	Yes
Clear Height:	24'
Loading Dock:	Yes
Grade Level:	Yes
Power:	3 Phase
Zoning:	M-1
Parking:	Ample
Lease Term:	3 - 5 Years
Lease Type:	NNN
NNN Costs:	\$0.11/SF

Listing Comments:

- Fully sprinklered.
- Dock and grade level doors.
- Excellent distribution location near the airport.
- Easy access to I-84 and major thoroughfares.
- Rail service on site.



Available Space:

SPACE:	RSF:	RATE/SF:
1237 Boeing	Whse 14,850 SF	\$0.33
1267 Boeing	Office 1,093 SF	
Available with 30-day notice	Whse 5,157 SF	
	Total: 6,250 SF	\$0.33
1115 Boeing	Office BTS	
	Whse 27,000 SF	
	Total: 27,000 SF	\$0.33
1063 Boeing	Office 790 SF	
	Whse 17,210 SF	
	Total: 18,000 SF	\$0.33
1051B Boeing	11,000 SF	\$0.33



Contact:

Dan Minnaert, SIOR, CCIM

Ph: 208.947.0845
Fx: 208.947.0869
dan@tokcommercial.com
www.tokcommercial.com

Devin Pierce

Ph: 208.947.0850
Fx: 208.947.0869
devin@tokcommercial.com
www.tokcommercial.com



(03/13/12)

This information was obtained from sources believed reliable but cannot be guaranteed. Any opinions or estimates are used for example only.

Airport Distribution Center

1051 - 1287 Boeing St. - Boise, ID
OFFICE / WAREHOUSE SPACE FOR LEASE

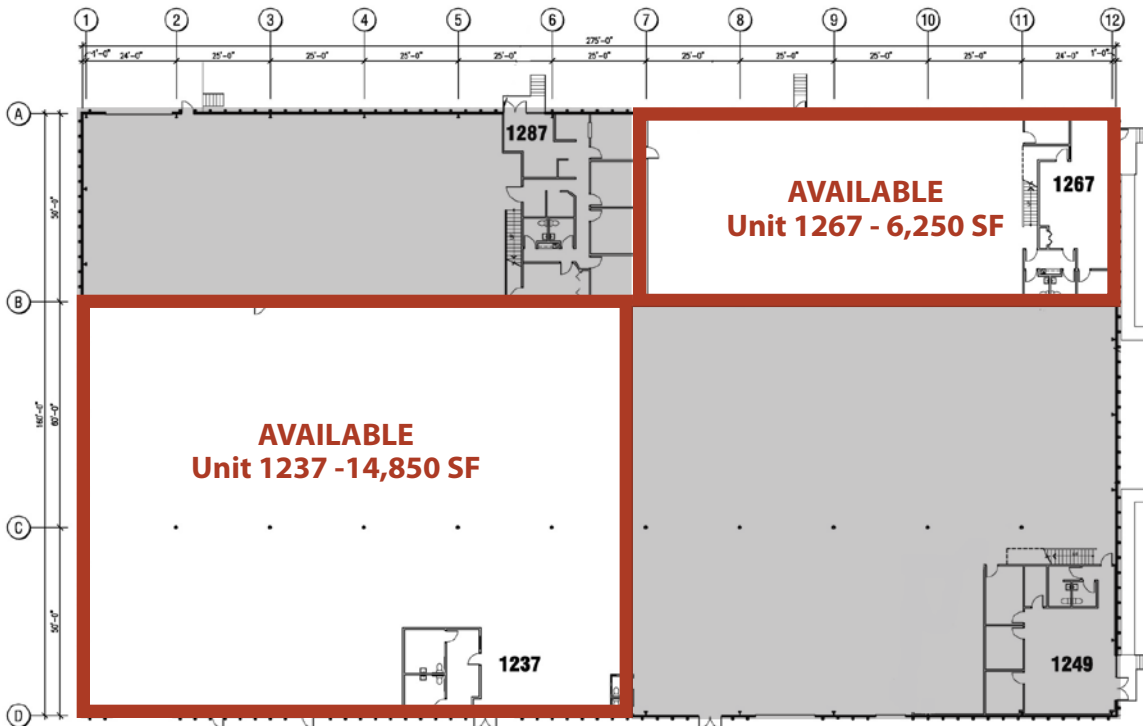

FLOOR PLAN
1237 - 1287 BOEING

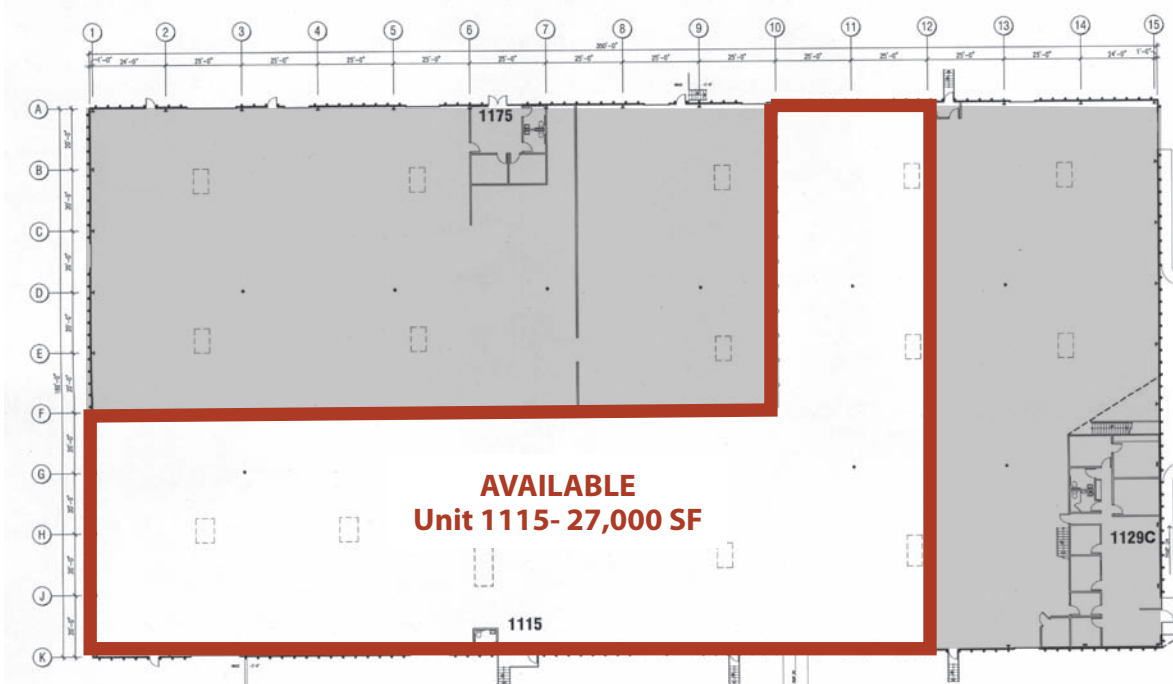

FLOOR PLAN
1115 - 1175 BOEING

This information was obtained from sources believed reliable but cannot be guaranteed. Any opinions or estimates are used for example only.

Airport Distribution Center

1051 - 1287 Boeing St. - Boise, ID
OFFICE / WAREHOUSE SPACE FOR LEASE

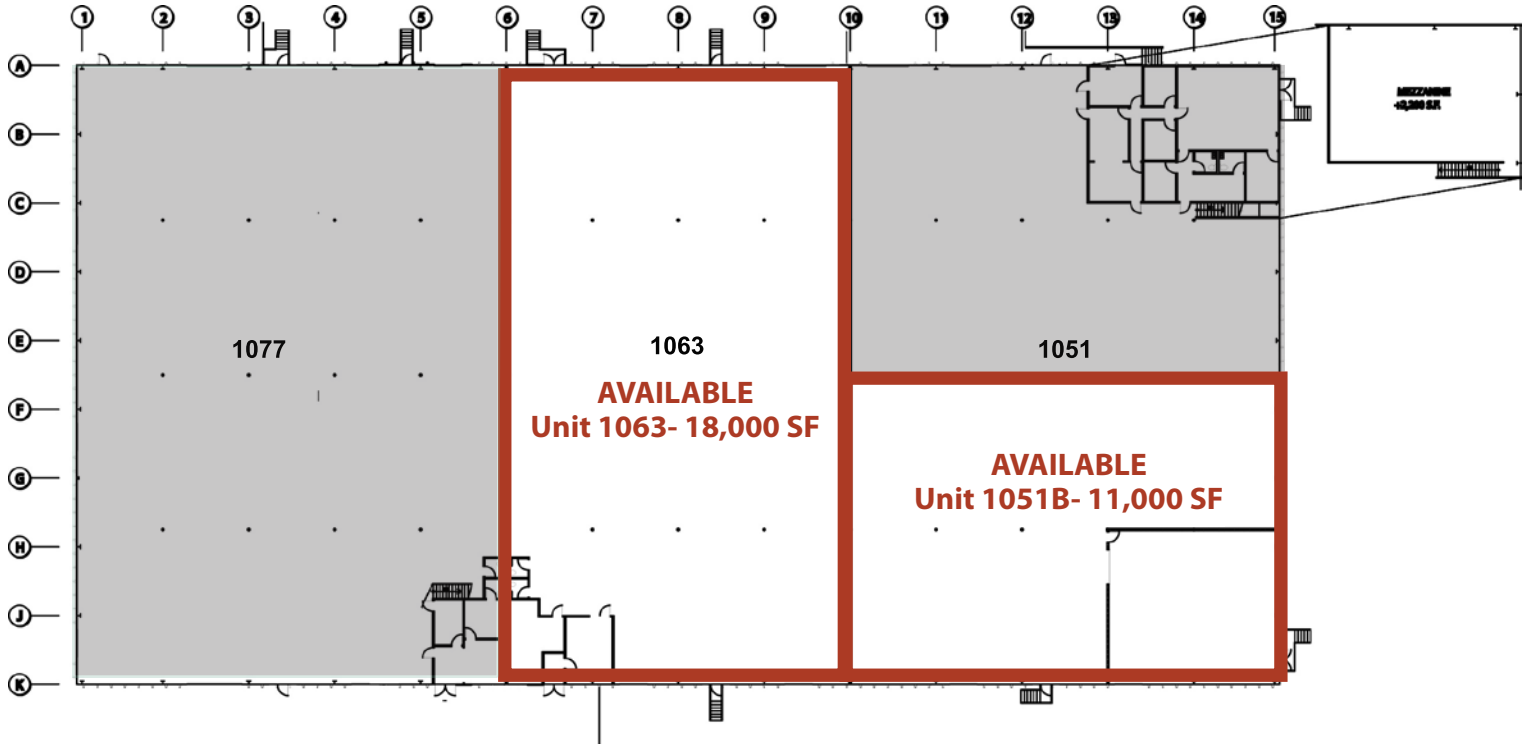

FLOOR PLAN
1051 - 1077 BOEING

This information was obtained from sources believed reliable but cannot be guaranteed. Any opinions or estimates are used for example only.

Airport Distribution Center

1051 - 1287 Boeing St. - Boise, ID
OFFICE / WAREHOUSE SPACE FOR LEASE

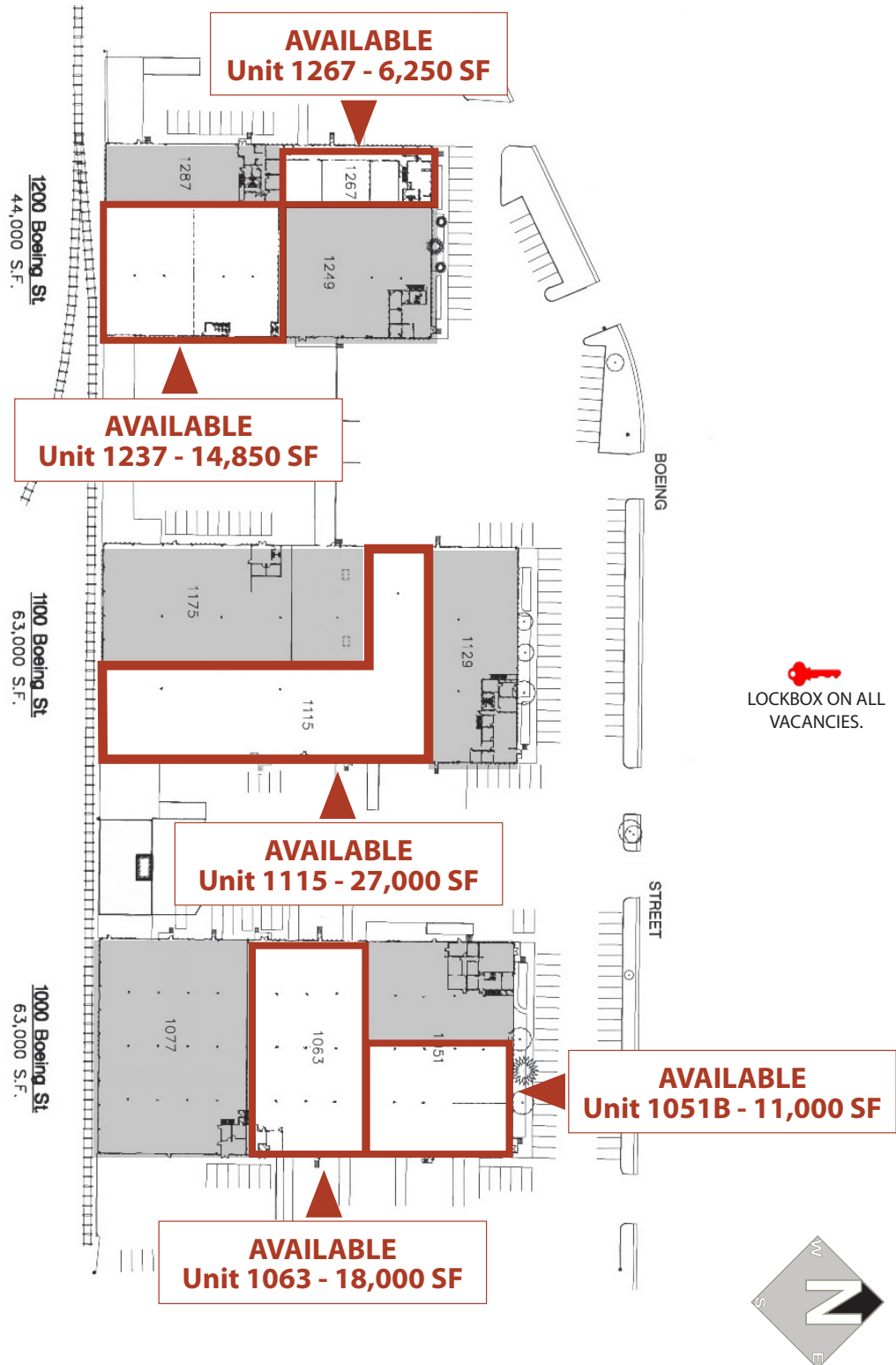

This information was obtained from sources believed reliable but cannot be guaranteed. Any opinions or estimates are used for example only.