

FORMER LARRY MILLER PONTIAC BUICK GMC

5803 & 5807 CLEVELAND BLVD., CALDWELL, ID 83607

RETAIL BUILDINGS & LAND FOR SALE / LEASE



THORNTON OLIVER KELLER

COMMERCIAL REAL ESTATE

Experience Results.

CONTACT:

John Stevens, CCIM

Ph: 208.947.0814

Fx: 208.947.0869

jstevens@tokre.com

www.tokre.com



LISTING COMMENTS:

- Former Auto Dealership

PROPERTY INFORMATION:

Submarket:	Caldwell
Available:	Immediately
5803 Cleveland:	20,176 SF Bldg. & 7.02 AC of Land
5807 Cleveland:	26,595 SF Bldg. & 3.96 AC of Land
Combined Lot Size:	10.98 AC
Divisible:	Yes
Zoning:	C-3 (Service Commercial)

5807 CLEVELAND LEASE TERMS:

RSF:	RATE/SF:	MONTHLY:
26,595 SF	\$7.50 NNN	\$16,622

SALE TERMS:

5803 Cleveland Price:	\$1,100,000.00
5807 Cleveland Price:	\$1,350,000.00
Total Sale Price:	\$5,658,000.00 \$2,450,000.00

(09/22/11) This information was obtained from sources believed reliable but cannot be guaranteed. Any opinions or estimates are used for example only.

FORMER LARRY MILLER PONTIAC BUICK GMC

5803 & 5807 CLEVELAND BLVD., CALDWELL, ID 83607

RETAIL BUILDINGS & LAND FOR SALE / LEASE



This information was obtained from sources believed reliable but cannot be guaranteed. Any opinions or estimates are used for example only.

250 S. FIFTH STREET • BOISE, IDAHO • 208.378.4600 • WWW.TOKRE.COM

FORMER LARRY MILLER PONTIAC BUICK GMC

5803 & 5807 CLEVELAND BLVD., CALDWELL, ID 83607

RETAIL BUILDINGS & LAND FOR SALE / LEASE

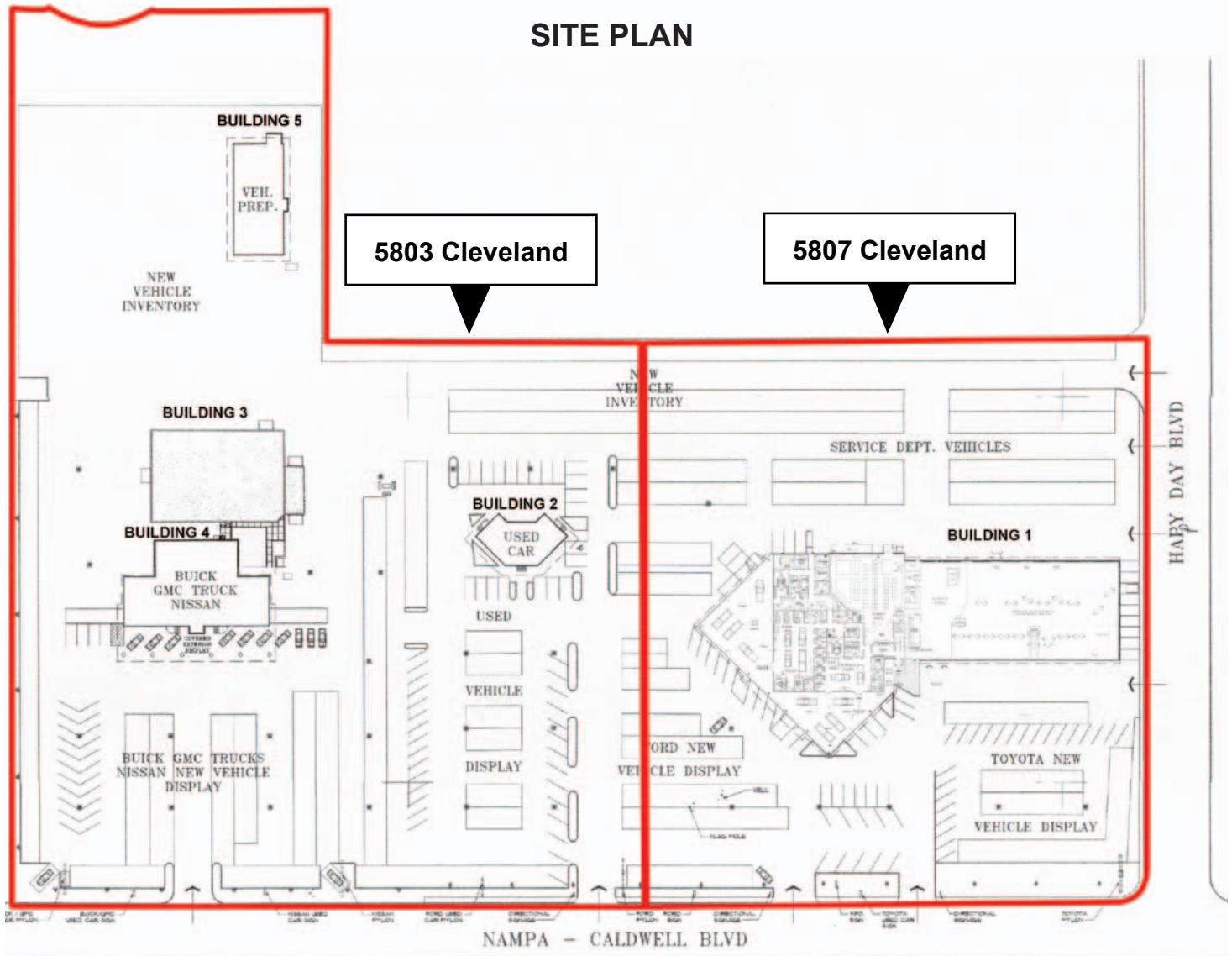

BUILDING 1 - Showroom & Service Facility	
Showroom/Sales/Office:	7,647 SF
Service Facility:	14,600 SF
Parts Facility w/Mezzanine:	4,348 SF
TOTAL	26,595 SF

BUILDING 2 - Used Car Sales Building	
Offices:	2,000 SF
TOTAL	2,000 SF

BUILDING 3 - Service Center	
Garage	
Office	
Storage/Mechanical	
TOTAL	10,327 SF

BUILDING 4 - Showroom	
Showroom:	3,736 SF
Office:	2,198 SF
Mechanical:	168 SF
TOTAL	6,102 SF

BUILDING 5 - Reconditioning Center	
Garage:	1,435 SF
Office:	165 SF
Storage/Mechanical:	200 SF
TOTAL	1,800 SF

This information was obtained from sources believed reliable but cannot be guaranteed. Any opinions or estimates are used for example only.

FORMER LARRY MILLER PONTIAC BUICK GMC

5803 & 5807 CLEVELAND BLVD., CALDWELL, ID 83607

RETAIL BUILDINGS & LAND FOR SALE / LEASE

BUILDING 1 FLOOR PLAN

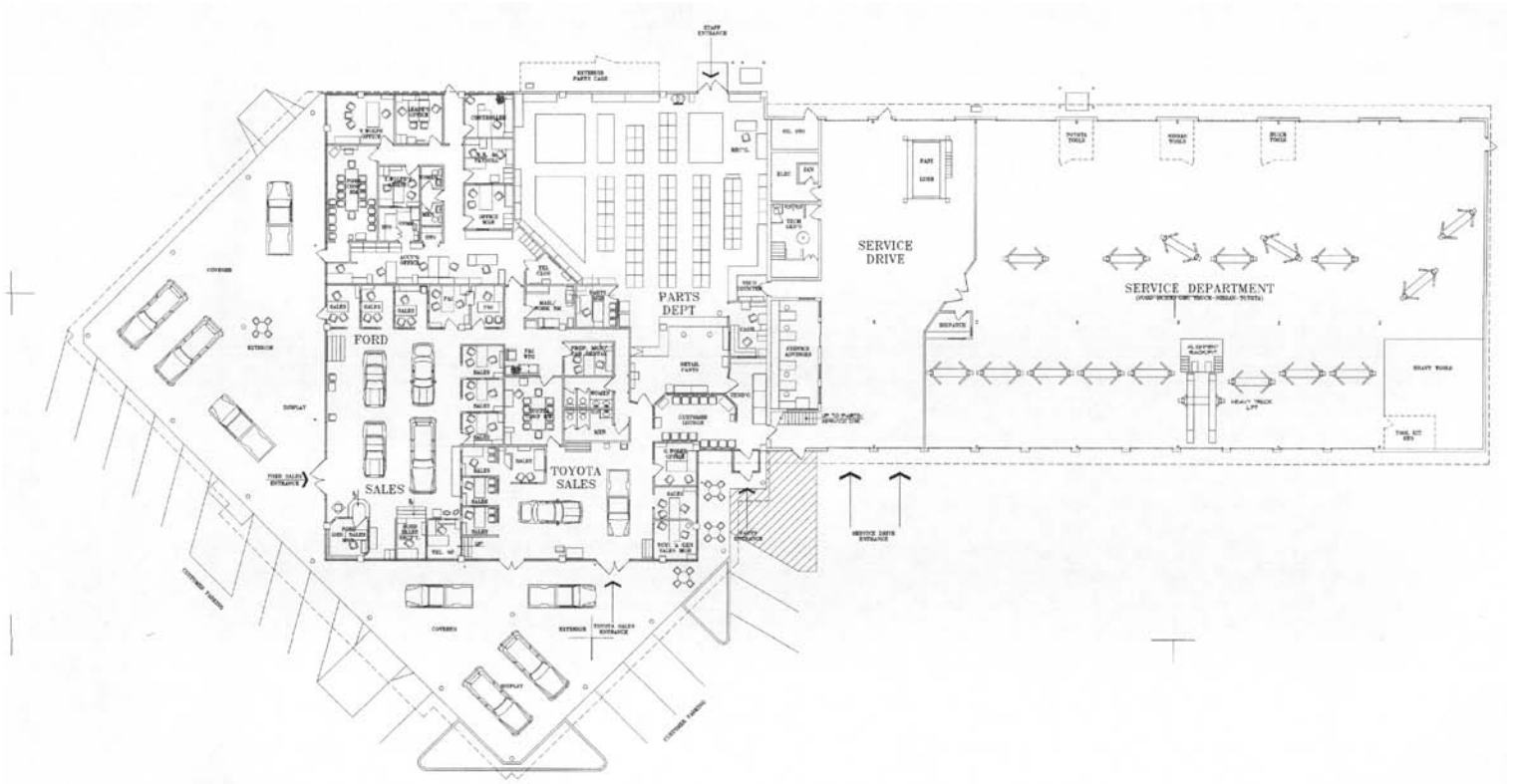

This information was obtained from sources believed reliable but cannot be guaranteed. Any opinions or estimates are used for example only.

250 S. FIFTH STREET • BOISE, IDAHO • 208.378.4600 • WWW.TOKRE.COM

FORMER LARRY MILLER PONTIAC BUICK GMC

5803 & 5807 CLEVELAND BLVD., CALDWELL, ID 83607

RETAIL BUILDINGS & LAND FOR SALE / LEASE

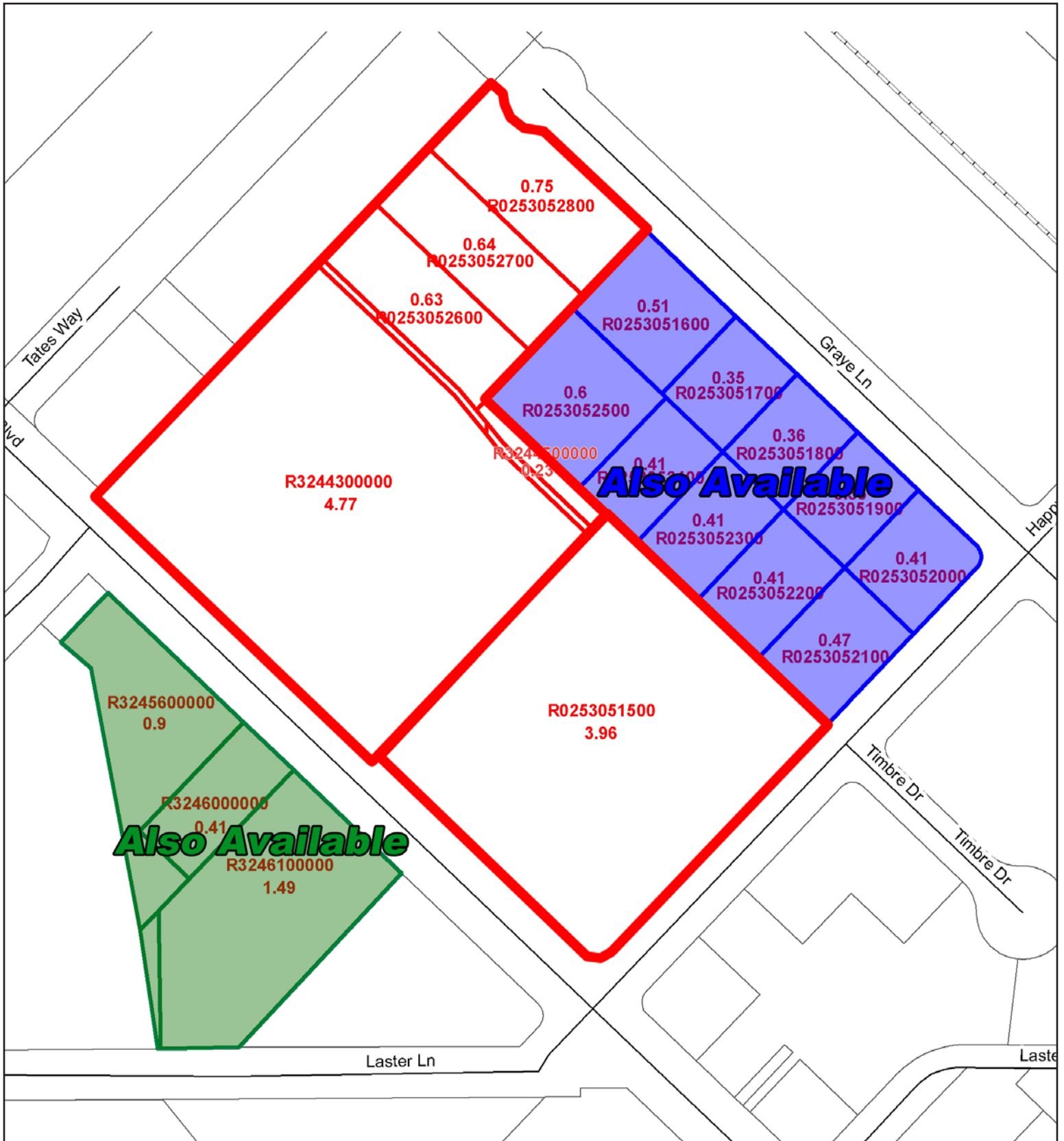

This information was obtained from sources believed reliable but cannot be guaranteed. Any opinions or estimates are used for example only.