

351 N. Mitchell

Boise, ID

INDUSTRIAL SPACE FOR LEASE



Property Information:

Submarket:	West
Available:	Immediately
Bldg Type:	Industrial
Bldg Size:	35,000 SF
Divisible:	Yes
Clear Height:	24'
Dock Doors:	Yes
Grade Level:	Yes
Power:	110/208
Zoning:	M-1D
Parking:	3/1,000 SF
Lease Term:	5 Yrs.
Lease Type:	NNN
NNN Costs::	\$0.13/SF (Estimate)

Listing Comments:

- Excellent exposure with showroom potential or second floor office.
- Quality tilt-up construction.
- Central location near Boise Towne Square Mall & I-84.
- Owner willing to build out to tenant specs.
- Call center potential with parking expansion to 10 per 1,000 SF possible.

Available Space:

SPACE:	RSF:	RATE/SF:	MONTHLY:
Ste 300	Office 350 SF		
	Whse 8,152 SF		-\$3,820.36
	Total 8,502 SF	\$0.40	\$3,400.80

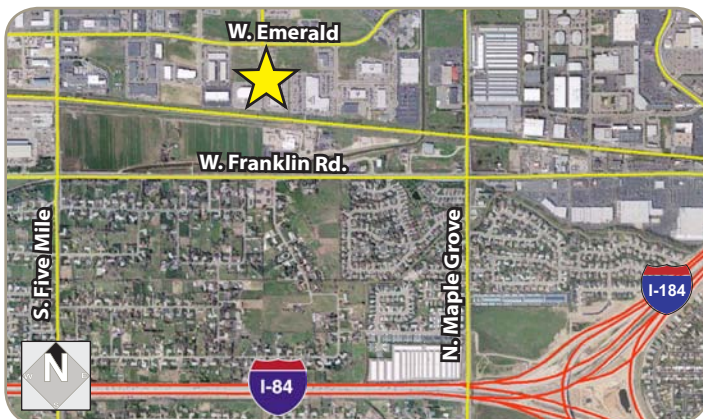

Contact:

Dan Minnaert, SIOR, CCIM

Ph: 208.947.0845
Fx: 208.947.0869
dan@tokcommercial.com
www.tokcommercial.com

Jerry Van Engen

Ph: 208.947.0840
Fx: 208.947.0869
jerry@tokcommercial.com
www.tokcommercial.com



351 N. Mitchell

Boise, ID

INDUSTRIAL SPACE FOR LEASE

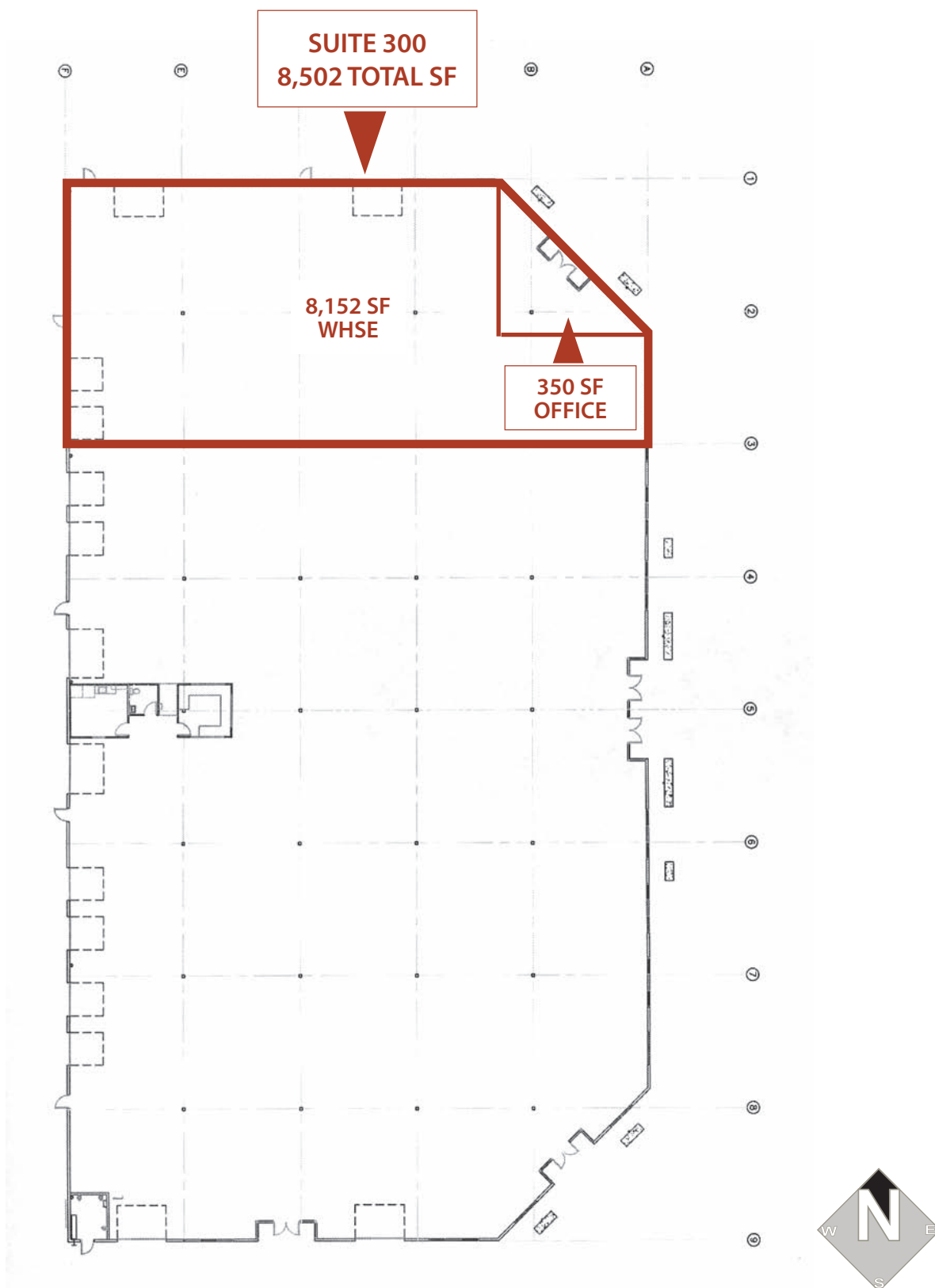

This information was obtained from sources believed reliable but cannot be guaranteed. Any opinions or estimates are used for example only.