

16141 20th Street

Nampa, ID

INDUSTRIAL SPACE FOR LEASE



Property Information:

Submarket:	Nampa
Available:	Now
Bldg Type:	Class A , Concrete Tilt
Bldg Size:	43,570 SF
Divisible:	17,000 - 34,000 SF
Clear Height:	24'
Dock Doors:	4
Grade Level:	4
Power:	3-Phase
Zoning:	I-L
Parking:	Ample

Listing Comments:

- Easy access off I-84, Franklin Exit.
- Both dock & grade level loading.
- Dead end street.
- 55' x 52' column spacing.

Available Space:

	RSF:	RATE/SF:	MONTHLY:
Office	2,350 SF		
Whs	17,000 - 34,000 SF		
Total:	19,350 - 36,350 SF	\$0.38/SF	\$7,353 - \$13,813
			+ NNN

Lease Terms:

Lease Term:	Flexible
Lease Type:	NNN
NNN Costs:	\$0.10/SF

Contact:

Dan Minnaert, SIOR, CCIM

Ph: 208.947.0845
Fx: 208.947.0869
dan@tokcommercial.com
www.tokcommercial.com

Devin Pierce

Ph: 208.947.0850
Fx: 208.947.0869
devin@tokcommercial.com
www.tokcommercial.com



(10/28/11)

This information was obtained from sources believed reliable but cannot be guaranteed. Any opinions or estimates are used for example only.

16141 20th Street

Nampa, ID

INDUSTRIAL SPACE FOR LEASE

LOCKBOX

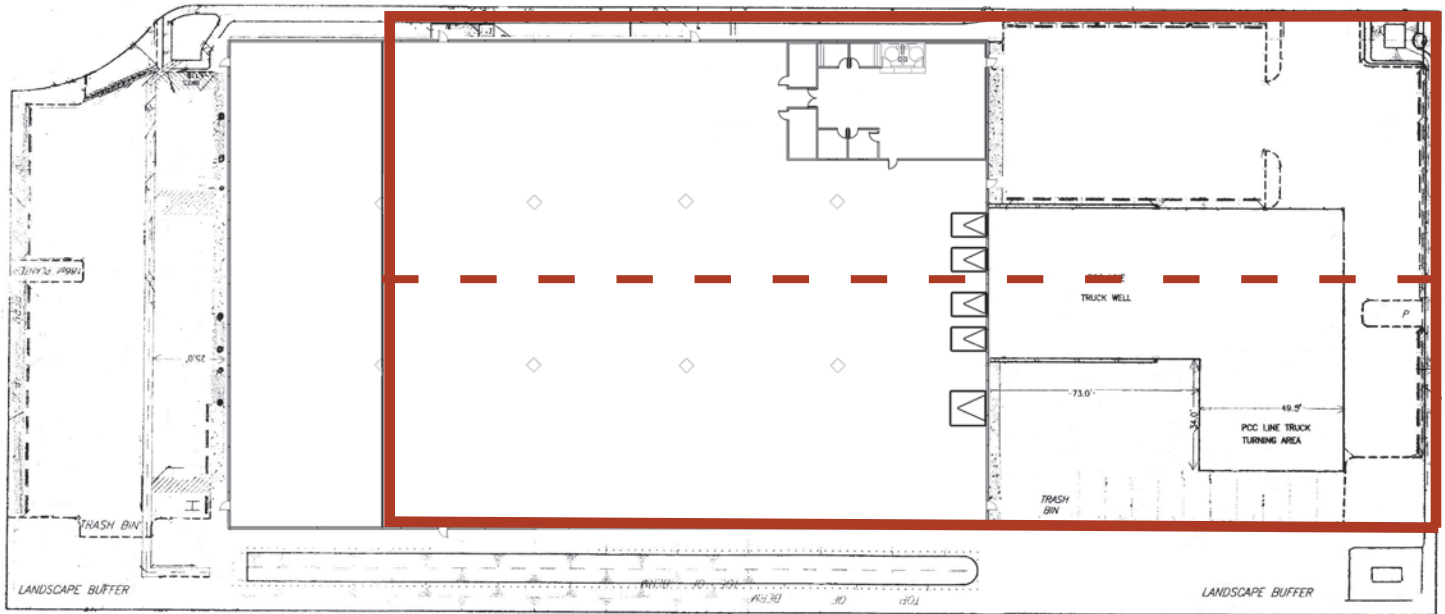

This information was obtained from sources believed reliable but cannot be guaranteed. Any opinions or estimates are used for example only.